

SINCE 1986

 **MADE IN CHINA**

ABOUT US

TIANRUI GROUP was established in 1986, the earliest manufacturer of poultry equipment and setter of poultry equipment industrial standards in China.

30 Years' Equipment Producing Experience. Focusing on manufacturing, researching and developing automatic layer, broiler and pullet raising equipment, TIANRUI provides customers with poultry farming solutions, including product research and development, project design, production, installation and service.

Over 20 Years' Chicken Raising Experience. TIANRUI has a 600,000 birds modern layer demonstration farm, a 1,000,000 pullets' demonstration farm, a broiler farm with an annual output of 1,000,000 birds and an organic fertilizer producing and processing base with the annual production capacity of 50,000 tons.

We have passed the authentication of ISO9000, ISO14000, OHSAS18001 and got 359 national patents. Our products are exported to many foreign markets, including more than 40 countries in Asia, East Europe, South America, Middle East and Africa.

TIANRUI not only has been the supplier of each cooperative partner, but also their farming consultant.



Qingdao Farming Port Animal Husbandry Machinery Co.,Ltd
Add:TIANRUI Business Park,No.185,Qingwei Road,Qingdao,China
Email:info@farmingport.com
Tel:+86 (532) 87692898
Fax:+86 (532) 87759096
www.farmingport.com



Let's make chicken raising easier together



➤ H TYPE LAYER RAISING EQUIPMENT

INTRODUCTION OF PRODUCT

- 1.The full set of equipment using hot-dip galvanized material, corrosion-resistant, which ensures the service life of 15-20 years.
- 2.Intensive management and automated control. Achieve automatic feeding,drinking,manure cleaning, egg collecting and environment control,can help to improve working efficiency and save labor cost.
- 3.High-density raising,saves land and investment.
- 4.Suitable for closed chicken house. Automatic control of ventilation and temperature can meet the requirement of the birds.

AUTOMATIC LAYER RAISING EQUIPMENT

H TYPE LAYER RAISING EQUIPMENT



Drawing of H Type Layer Raising Equipment

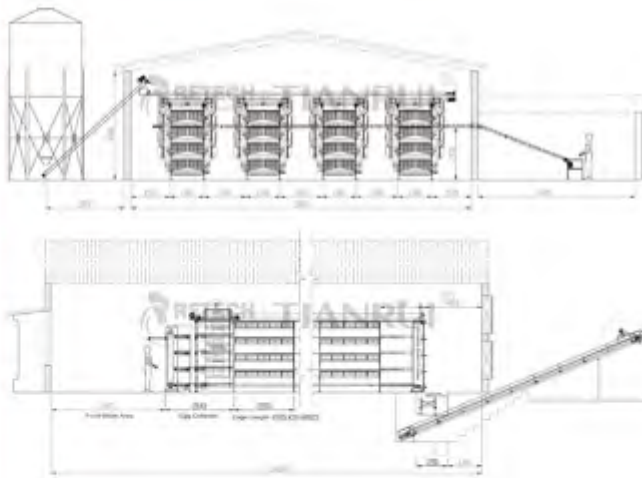

Explanation

In a house of 100m*13m, if 4 tier cages are installed, 39 units of cage per line, the height of side wall should be 4m, and total birds quantity is 37440; if 5 tier cages are installed, 39 units of cage per line, the height of side wall should be 4.5m, and total birds quantity is 46800; if 6 tier cages are installed, 39 units of cage per line, the height of side wall should be 5.0m, and total birds quantity is 56160.

20 YEARS' CHICKEN RAISING EXPERIENCE

30 YEARS' EQUIPMENT PRODUCING EXPERIENCE

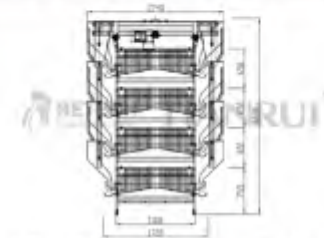

9CLD-4240 parameters of cage and frame

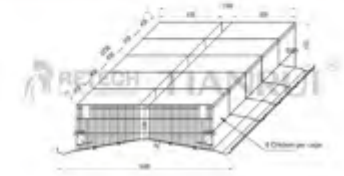

9CLD-4240 parameters of cage

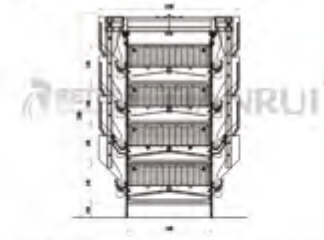

9CLD-4272 parameters of cage and frame

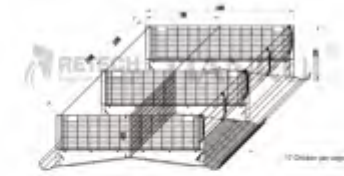

9CLD-4272 parameters of cage

Specification list of H type cage systems:

Model	Tiers	Doors/set	Birds/door	Capacity/set	Size(L*W*H)mm	Area/bird(cm ²)	Type
9CLD-3180	3	5	6	180	2250*600*430	450	H
9CLD-4240	4	5	6	240	2250*600*430	450	H
9CLD-5300	5	5	6	300	2250*600*430	450	H
9CLD-6360	6	5	6	360	2250*600*430	450	H
9CLD-4272	4	2	17	272	2400*700*520	494	H
9CLD-5340	5	2	17	340	2400*700*520	494	H
9CLD-8544	8	2	17	544	2400*700*520	494	H
9CLD-9612	9	2	17	612	2400*700*520	494	H
9CLD-10680	10	2	17	680	2400*700*520	494	H

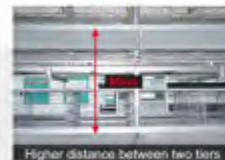

Features

1. Reasonable distance between two tiers, better for ventilation.
2. Two water line ensure the sufficient water for all layers.
3. Reasonable space design between two sides cage, better for ventilation.